



MJ

Chain Connector



Norm EN 1677-1

These connectors provide fast, easy assembly without the need for special tools or skills.
Designed for attaching hooks, master links and other end fittings to Grade 8 alloy steel chains.

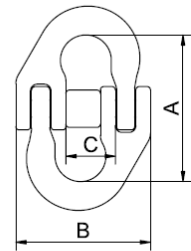

Code	WLL	Chain Ø	Dimensions in mm			BF	Weight
	t		mm	A	B	C	
MJ 6	1.12	6	45	40	15	4.5	0.14
MJ 7/8	2.00	7/8	54	52	20	8.0	0.15
MJ 10	3.15	10	63	65	25	12.6	0.32
MJ 13	5.30	13	84	82	30	21.2	0.68
MJ 16	8.00	16	104	103	36	32.0	1.26
MJ 18/20	12.50	18/20	127	120	45	50.0	2.02
MJ 22	15.00	22	155	144	51	60.0	3.18
MJ 26	21.20	26	160	172	57	84.8	4.52
MJ 32	31.50	32	174	197	69	126.0	8.20