



COI

S/s Omega link

316 L/1.4404

It is an easy and safe connection between the chain and the components.

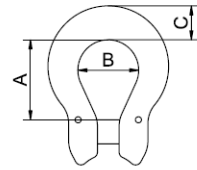

| Code | WLL | Chain Ø | Dimensions in mm | | | BF | Weight |
|----------|------|---------|------------------|----|----|------|--------|
| | t | | A | B | C | t | Kg |
| CO 6 I | 0.70 | 6 | 25 | 20 | 9 | 2.8 | 0.07 |
| CO 7/8 I | 1.20 | 7/8 | 34 | 23 | 16 | 4.8 | 0.16 |
| CO 10 I | 1.60 | 10 | 41 | 31 | 17 | 6.4 | 0.28 |
| CO 13 I | 2.70 | 13 | 54 | 40 | 21 | 10.8 | 0.63 |