

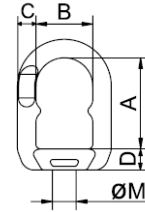

ELI S/s Eye nut

316 L/1.4404

These eye nuts have a flat section that is designed to accommodate omega links (code COI).
They have ISO metric threads as standard, however other thread types can be supplied on request.



Code	Type	WLL	Ø ISO	Dimensions in mm				BF	Weight
		t	M	A	B	C	D	t	Kg
EL 12 I	7/8	0.60	12	48	32	12	17	3.0	0.25
EL 14 I	7/8	0.80	14	48	32	12	17	4.0	
EL 16 I	10	1.00	16	60	37	14	18	5.0	0.40
EL 18 I	10	1.50	18	60	37	14	18	7.5	
EL 20 I	10	2.00	20	60	37	14	18	10.0	
EL 22 I	13	2.50	22	75	48	16	23	12.5	0.67
EL 24 I	13	3.00	24	75	48	16	23	15.0	
EL 27 I	13	3.50	27	75	48	16	23	17.5	