



GC-GCV Shortening clutch



Norm EN 1677-1

Shortening clutches are an essential part of chain slings, used to shorten the lengths of the chain legs and prevent instability of the loads. Shortening clutches are also available with a locking system, designed to prevent accidental disengagement of the chain.

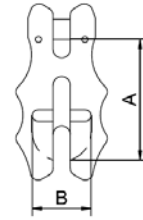

Code	Code	WLL	Chain Ø	Dimensions in mm		BF	Weight
				t	mm		
Without lock	With lock	t	mm	A	B	t	Kg
GC 6	GCV 6	1.12	6	54	22	4.5	0.22
GC 7/8	GCV 8*	2.00	7/8	65	30	8.0	0.41
GC 10	GCV 10	3.15	10	77	38	12.6	0.75
GC 13	GCV 13	5.30	13	105	49	21.2	1.63
GC 16	GCV 16	8.00	16	131	60	32.0	3.15
GC 18/20	GCV 20**	12.50	18/20	143	76	50.0	4.06

* Only for 8 mm chain.

** Only for 20 mm chain.
GCV only yellow painted.