

TOWING ARM

Provides traction on the current collector trolley for its movement in the system.

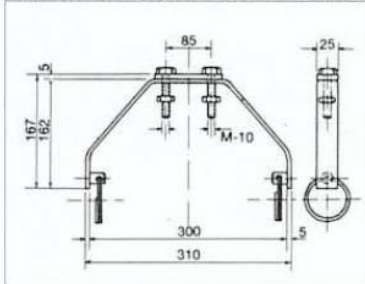

Ref. BA-4

Ref. BA-4. Single arm for trolley TO-4x35A and TO-4x35AC.

Ref. BA-4C. Single arm with connection box.

Ref. BA-70 Double arm with connection box for double trolley TO-4x70A.

- In epoxy coated steel.

- Weight BA-4 : 780 grms.



Ref. BA-4



Ref. BA-4C



Ref. BA-70